



***XHD Lithium
Cordless Grease
Gun 18V -
Bare Tool***

TSC37



OPERATORS MANUAL



TABLE OF CONTENTS

Specifications	3
Product Identification	4
Safety Guidelines	5
LCD Operation	9
Operation	10
Maintenance	14
Troubleshooting	15
Exploded Parts List	16

Note

This manual is for your reference only. Due to the continuous improvement of the XHD Lithium products, changes may be made at any time without obligation or notice.

Thank You

For the purchase of this XHD Lithium product. We try our hardest to supply customers like you with the best quality products available, at the best price possible. We cant wait to continue working together in the future.



SPECIFICATIONS

Voltage	18 Volts Maximum
Maximum Peak Pressure	10000 PSI (689 Bar)
Operating Temperature	-10° to 40°C
High Output (H)	8000–10000 PSI (689 bar max)
Low Output (L)	4000–6000 PSI (413 bar max)
Flow Rate	High: 130–150 g/min Low: 80–100 g/min
Grease Tube	450g (15oz)
Outlet Hose	1060mm
Outlet Coupler	4 Jaws
Charge Time	45–120 minutes

Intended Use

The battery grease gun was exclusively designed to pump and dispense lubricant using 18V battery power. Do not exceed the maximum specification ratings.

PRODUCT IDENTIFICATION

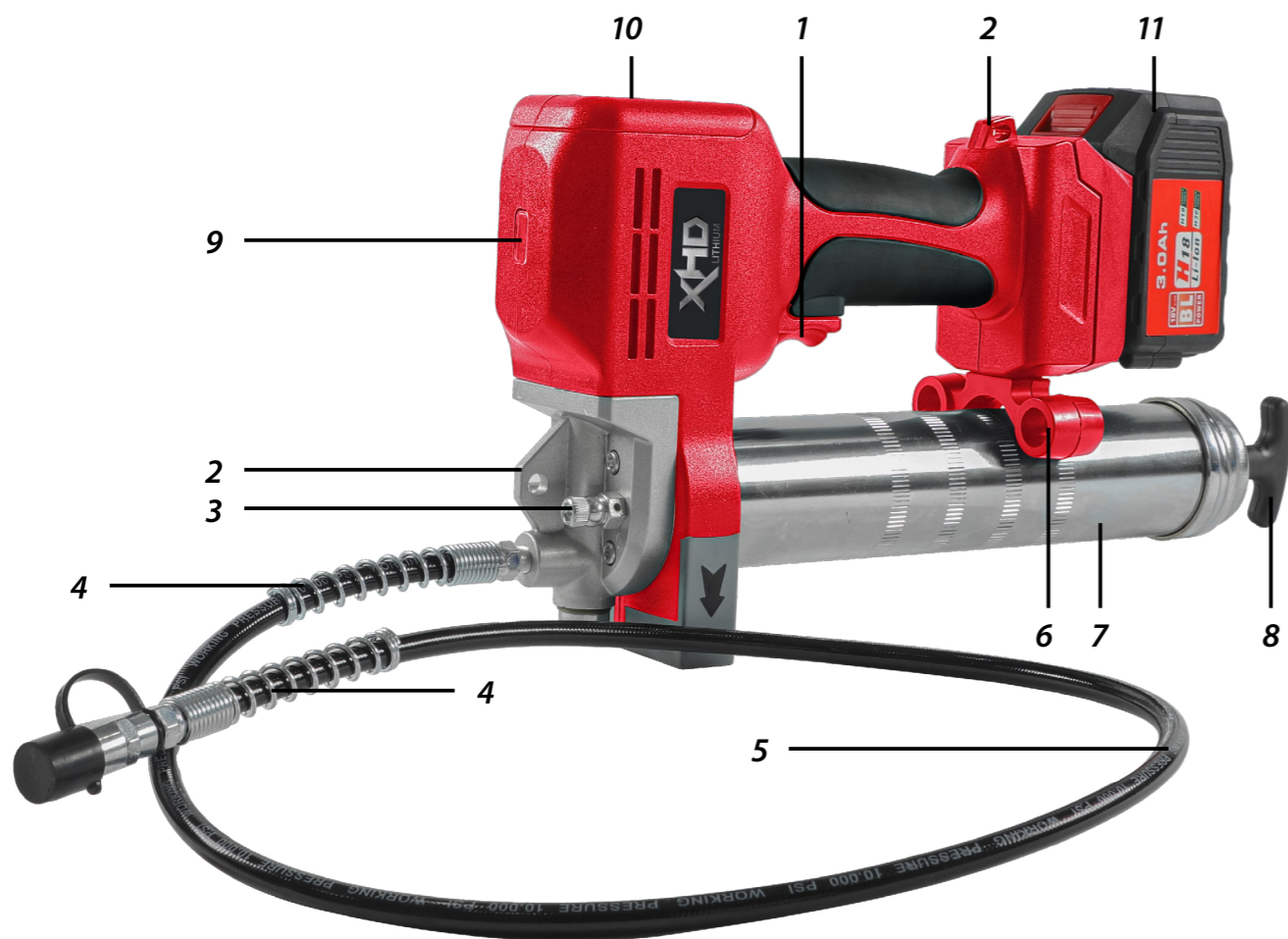

- 1 On/Off Trigger
- 2 Strap Fixtures
- 3 Air Drain
- 4 Spring Strain Relief
- 5 Flexible Hose
- 6 Hose Holder
- 7 Barrel
- 8 Rod Handle
- 9 Work Light
- 10 LCD Panel
- 11 XHD Lithium Battery (Not Included)

SAFETY GUIDELINES



WARNING

READ ALL SAFETY WARNINGS & INSTRUCTIONS. Failure to follow instructions and warnings could lead to serious injury, electric shock, or fire.

Work Area Safety

- **Ensure that your work area is kept clean and well lit.** Lack of visibility and clutter greatly increase the risk of accident when using tools.
- **Keep bystanders, pets, and children clear when operating this power tool or machine.** They can cause distraction or risk injury to themselves.
- **Ensure you are not operating the power tool or machinery in the presence of dust, liquids, flammable gases, or anything that can create an explosive atmosphere.** Power tools and machinery can create sparks which can lead to ignition and fire hazards in working environments.

Personal Safety

- **Always wear personal protective equipment (PPE).** Eye protection, ear protection, dust masks, and other protective equipment will help to reduce the risk of personal injury or long-term illnesses.
- **Dress appropriately. DO NOT wear loose clothing that can get caught in moving parts.** Keep hair, loose clothing, jewellery, and anything else that could be of risk, away

from moving parts in the machine, or they could become caught therein.

- **Always remain alert and DO NOT operate power tools or machinery under the influence of any substances such as alcohol or drugs, including prescription medications.** Lack of focus could lead to injury or accidents while operating these power tools and machinery.
- **Always ensure proper footing and balance.** Overreaching can lead to slipping and falling which can result in injury or accident.
- **Ensure the power switch is in the OFF position before connecting any battery, or power source to the power tool or machinery.** This can cause injury as tools and machinery can suddenly fire incidentally when live, causing accidents.
- **Use all provided dust collection and extraction attachments, if included.** This equipment, along with the use of PPE dust masks, can help keep you safe from dust inhalation, and keep your work site clear from hazards.
- **Ensure loose parts such as wrenches or adjusting keys are removed before starting the power tool or machinery.**



SAFETY GUIDELINES

Power Tool & Machinery Use & Care

- **Use the correct tool for the job.** Forcing a tool to do a job it was not designed for increases the risk of accident or injury.
- **Disconnect tools and machinery from power, or remove batteries before doing any maintenance or adjustments, or before storing the tools and machinery.** This reduces or removes the risk of a power connection that causes the tool or machinery to accidentally fire, which can help prevent injury or accident.
- **Check the general condition of the power tool for damage or any problems that could affect the way the tool or machine works.** An unrepaired tool or machine can lead to accident and injury. Only have your tool or machine repaired with genuine parts from your local distributor
- **Only use the power tool and machinery with genuine parts or accessories that are designed to be used with this power tool and machinery.** Failure to do so could result in accident or injury, or damage your tool or machinery.
- **Store your tool or machinery out of reach of children, and away from untrained personnel when not in use.** Use by somebody untrained, or a child, could lead to accident or serious injury.

Service

- **Have your tools and machinery serviced by your local distributor with genuine XHD Lithium replacement parts.** This will ensure that the safety of the power tool or machine is maintained.

 **WARNING**

The warnings and precautions discussed in this manual cannot cover all possible conditions and situations that may occur. It must be understood by the operator that common sense and caution are factors which cannot be built into this product, but must be supplied by the operator.

Always Use Common Sense

- It is not possible to cover every conceivable situation you can face. Always exercise care and use your common sense. If you get into a situation where you feel unsafe, stop and seek expert advice. Contact your dealer, service agent, or an experienced user. Do not attempt any task you feel unsure of!
- **Do not let familiarity gained from the frequent use of tools allow you to become complacent and ignore tool safety principles.** A careless action can cause severe injury within a fraction of a second.



SAFETY GUIDELINES

Battery Tool Use & Care

- Prevent unintentional starting. Ensure the switch is in the OFF position before connecting to the battery pack, picking up, or carrying the machine. Carrying the machine with your finger on the switch or energising a machine that has the switch ON invites accidents.
- Disconnect the battery pack from the machine before making any adjustments, changing accessories, or storing the machine. Such preventive safety measures reduce the risk of starting the machine accidentally.
- Recharge the battery only with the charger specified by the manufacturer. A charger that is suitable for one type of battery pack may create a risk of fire when used with another battery pack.
- Use machines only with specifically designated battery packs. Use of any other battery packs may create a risk of injury and fire.
- When the battery pack is not in use, keep it away from other metal objects, like paper clips, coins, keys, nails, screws, or small metal objects, that can make a connection from one terminal to another. Shorting the battery terminals together may cause burns or a fire.
- Under abusive conditions, liquid may be ejected from the battery; avoid contact. If contact accidentally occurs, flush the area with water. If liquid contacts eyes, seek medical help. Liquid ejected from the battery may be acidic and may cause irritation or burns.
- Do not use a battery pack or machine that is damaged or modified.

fied batteries may exhibit unpredictable behaviour resulting in fire, explosion, or risk of injury.

- Do not expose a battery pack or machine to fire or excessive temperature. Exposure to fire or temperature above 130°C may cause explosion.
- Follow all charging instructions and do not charge the battery pack or machine outside of the temperature range specified in the instructions.
- Charging the battery improperly, or at temperatures outside of the specified range may damage the battery and increase the risk of fire.
- Have servicing performed by a local XHD distributor repair person using only identical replacement parts. This will ensure that the safety of the product is maintained.
- Do not modify or attempt to repair the machine or the battery pack except as indicated in the instructions for use and care.

Battery Long Life Tips

- Charge the battery cartridge before it is completely discharged. Always stop tool operation and charge the battery cartridge when you notice less tool power.
- Never recharge a fully charged battery cartridge. Overcharging shortens the battery service life.
- Charge the battery cartridge with room temperature at 10°C – 40°C. Allow a hot battery cartridge to cool before charging it.
- Charge the battery cartridge once in every six months if you do not use it for extended periods at a time.

SAFETY GUIDELINES

Grease Gun Specific Safety

- Parts of the tool or the hose assembly can break or rupture due to high pressure, posing a risk of serious injury. Before use, always inspect the tool and hose assembly for any signs of damage or wear. Never use the tool if any part is damaged or worn.
- Use only approved flexible hoses. Always hold the hose by the flexible hose safety spring guard to avoid serious personal injury.
- If the hose kinks or becomes damaged, a rupture may occur, potentially causing serious injury. Replace the hose immediately at the first sign of wear, kinks, or damage.
- To reduce the risk of serious personal injury, do not use the grease gun near or on moving parts, mechanisms, or running equipment.
- Do not operate without proper safety apparel, including eye protection.
- Hold the Hose Assembly by the spring strain relief to avoid kinking the hose.
- The output may be at high pressure. Do not direct the discharge at yourself or others.
- Extreme pressure may cause the nozzle extension or whip hose to burst. Use only approved hoses and carefully follow all whip hose instructions and warnings.

WARNING

Risk of fire. Grease may be flammable. Do not expose to high temperatures or flames. Read and follow all warnings and instructions from the lubricant manufacturer.

WARNING

Risk of Infection or Severe Injury. Ruptured components can inject grease into the skin or eyes, leading to serious injury or infection. Do not treat this as a simple cut. Seek immediate medical attention.

WARNING

The grease gun may generate high pressure up to 10000PSI (689 bar). Always wear gloves during operation. Keep hands clear of the exposed rubber portion of the hose.

LCD OPERATION

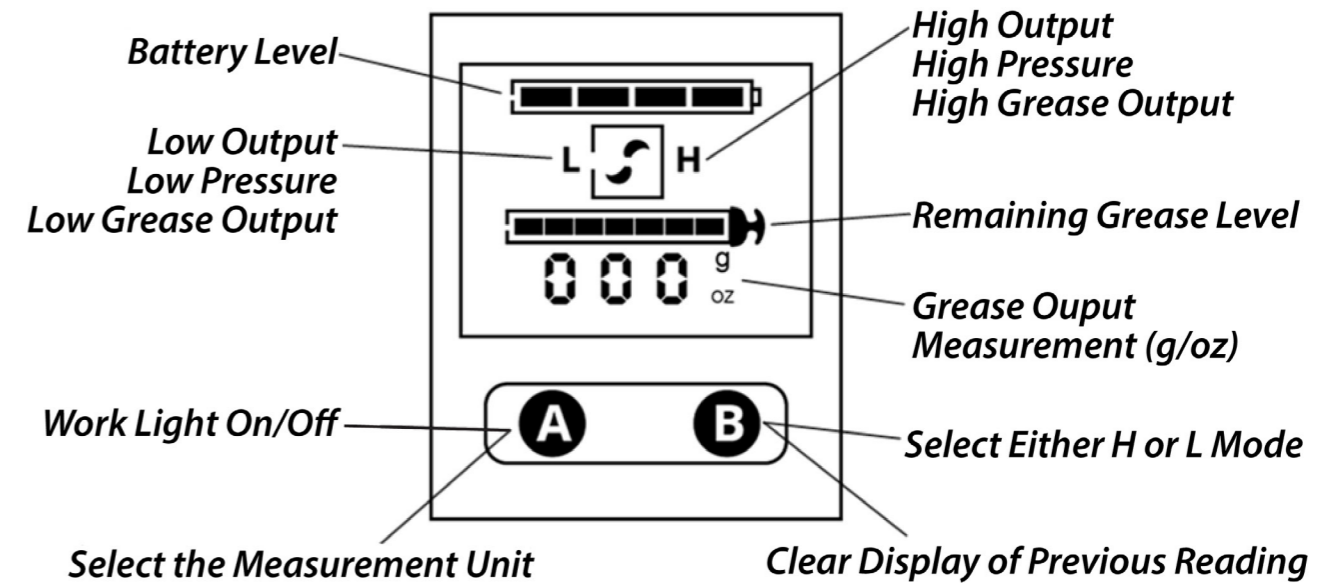

Red Flashing Warning: Loss of Priming Fault

Control Centre

- To avoid high current draw (over 40 Amps), the circuit board will automatically shut down the circuit to prevent potential damage to the tool.
- The LED indicators display battery status, pumping speed, and grease output.

2 Speed Selection

- Press the "B" button to choose between High (H) or Low (L) output modes. Refer to the Specifications for output details.

Recharge the Battery

- The LCD display shows when the battery level is low. Recharge the battery promptly.

Clear Reading

- Press the "B" button for 8–10 seconds to clear the display of the previous reading.

LCD Display & Light

- The trigger turns the LCD display and grease gun on or off.
- Press the "A" button to control the work light.
- The LCD display will automatically turn off after 20 seconds of inactivity.

Grease Flow Monitoring

- Press and hold the "A" button for 8–10 seconds to change the grease output measurement unit from Ounces to Grams (or from Grams to Ounces).
- A flashing red LCD indicates that the grease is used up. Replace the grease cartridge or refill the tube as needed.
- After each refill or cartridge replacement, prime the grease gun by operating it until grease flows from the hose. Use the vent valve to expel any air pockets.

OPERATION

Battery Charging

1. Plug the battery charger into the socket. The power indicator light will turn green.
2. Slide the battery pack into the charger's slot until you hear a click, indicating that the battery pack is securely in place. The power indicator light will turn off, and the charging indicator light will turn red, signalling the start of the charging process.
3. After approximately 2 hours (for a 5.0Ah battery), the charging indicator light will turn off, and the power indicator light will turn green again, indicating that the charging process is complete.
4. Unplug the charger, and then remove the battery pack from the charger.

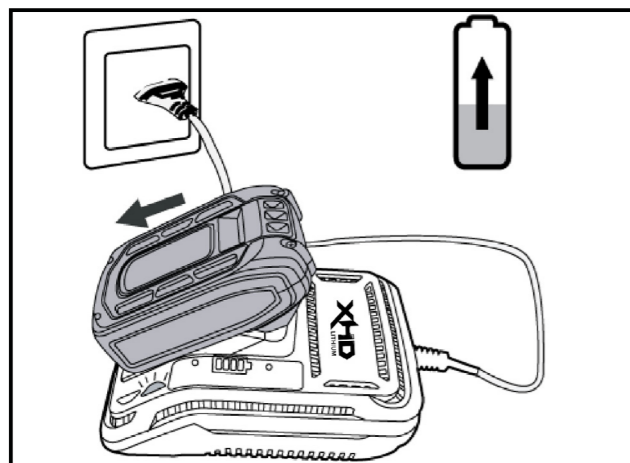
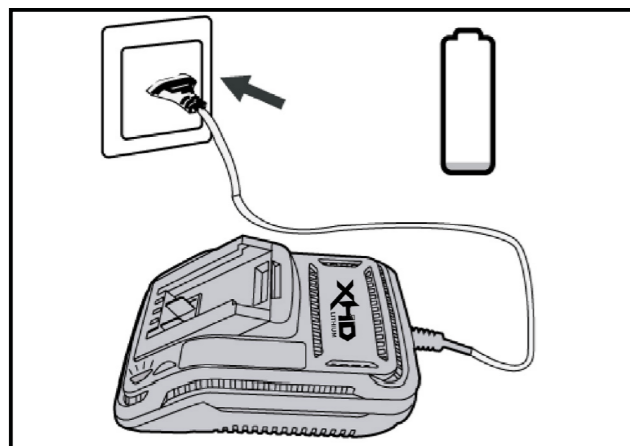
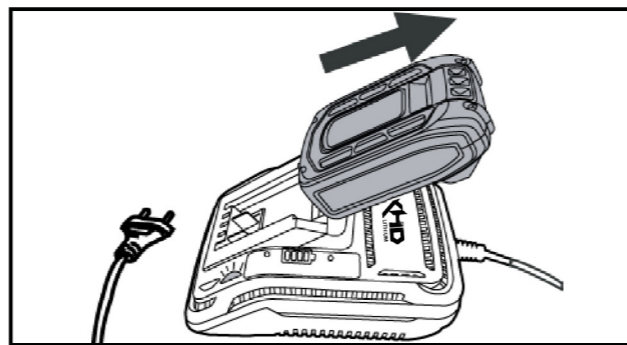
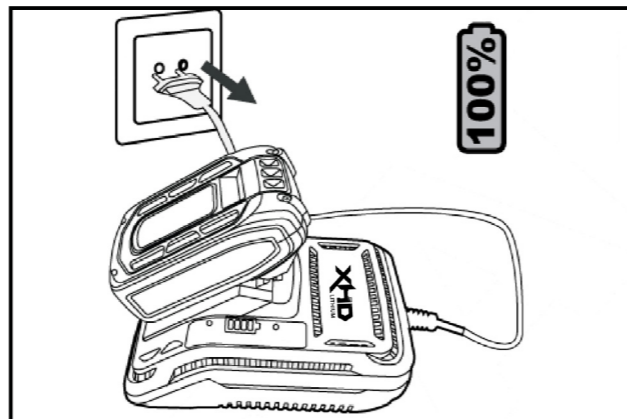

Charging Tips (Fig.3)

- After use, the battery pack may be slightly hot. If this happens, the battery pack cannot be charged immediately. Allow it to rest and cool down before attempting to charge it.

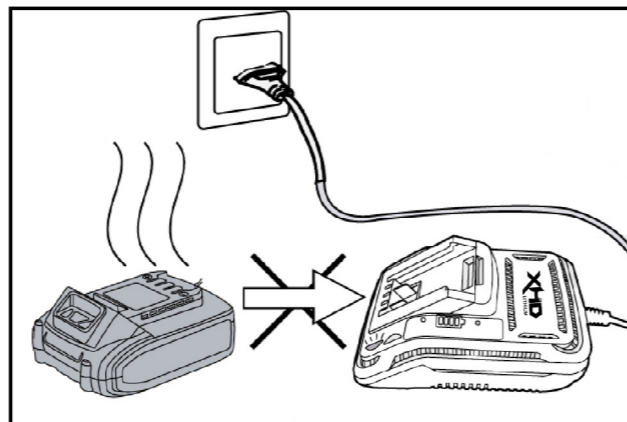

OPERATION

Indicating the Remaining Battery Capacity

- Press the check button on the battery cartridge to indicate the remaining battery capacity. The indicator will light up for few seconds.

NOTE: Depending on the conditions of use and the ambient temperature, the indication may differ slightly from the actual capacity.

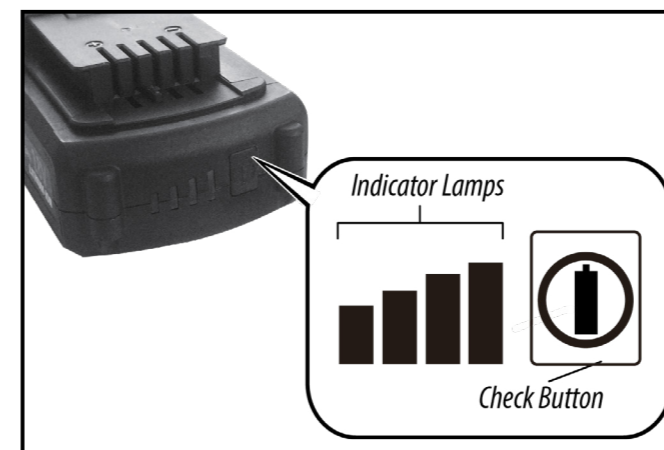

INDICATOR LAMPS			REMAINING CAPACITY
LIGHTED	OFF	BLINKING	
■	■	■	75% to 100%
■	■	□	50% to 75%
■	□	□	25% to 50%
■	□	□	0% to 25%
▣	□	□	Charge the Battery.
■	■	□	The Battery may have Malfunctioned
□	□	■	

NOTICE

Always unscrew the vent valve when replacing cartridge. This will allow air to escape from cartridge and prime grease gun.

NOTICE

Remove air pockets! Air pockets in the cartridge will prevent grease from being pumped and cause the grease gun to lose its prime. Unscrew the vent valve several times to remove small air pockets trapped in this area.

OPERATION

Installing a Grease Cartridge

1. Unscrew the grease barrel assembly from the cordless grease gun.
2. Pull back on the follower handle until the follower rod is fully extended and latch the follower rod groove into the slot on the tube end cap of the Grease Tube.
3. Remove the plastic cap from the grease cartridge and twist the cartridge into the barrel.
4. Remove the pull tab seal from the grease cartridge.
5. Screw the grease barrel assembly, with the new cartridge inside, back to the grease gun head.
6. Release the follower rod from its slot to allow it to go forward. Purge air from assembly.

NOTE: Reset display reading after purging air.

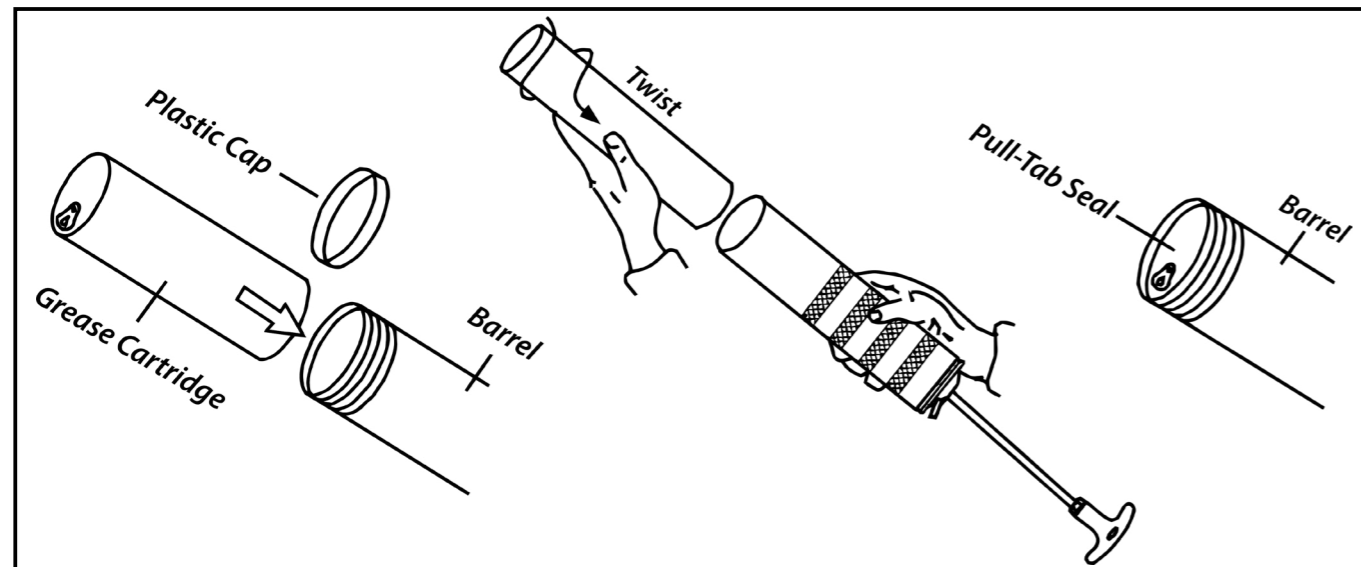

To Fill the Gun from a Bulk Container

1. Remove grease tube from the gun.
2. Insert the open end of the grease tube assembly into lubricant. Slowly pull the follower handle back while pushing the grease tube assembly deeper into the lubricant to prevent air pockets from being pulled into the grease tube assembly.
3. When the follower rod is fully extended, pull it sideways to latch the rod groove into the keyhole slot in the grease tube assembly cap.
4. Screw the Grease Tube into the gun and release the follower rod from the slot on the end cap of the tube to allow the follower rod go forward.
5. Clean any excess grease of the gun body.
6. Purge all air from assembly. (See air purging instruction).

NOTE: Reset display reading after purging air.

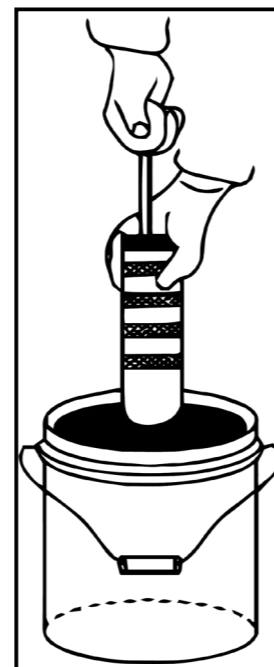

OPERATION

To Fill the Gun With a Filler Pump

1. A bulk filler fitting will need to be installed in the Grease Gun Head Cap (not included).
2. Replace the pipe plug in the head cap with the bulk loader fitting.
3. Engage the follower rod with the follower by rotating the follower handle.
4. Insert the gun filler nipple into the filler pump socket.
5. Operate the filler pump to fill the container. When the follower rod groove is exposed, the grease tube assembly is filled.
6. Disengage the follower rod from the follower by rotating the follower handle. Push the follower rod into the grease tube assembly.
 - Do not overfill!

NOTE: Reset display reading after purging air.

To Expel Air Pockets (Pressure Relief Valve)

1. Free the follower rod from the grease tube assembly cap and unscrew the vent valve when pushing the follower rod forward.
2. Unscrew the vent valve several times to operate the gun until all of the trapped air is expelled. Push the follower rod into the grease tube assembly.



MAINTENANCE

- Before cleaning or performing any maintenance, you must ensure the tool is switched off and disconnected from the power supply.
- Compressed air is the most effective way to clean this tool. Always wear PPE safety goggles when cleaning tools with compressed air.
- Ventilation openings and switch levers must be kept clean. DO NOT attempt to clean by inserting pointed objects through openings.
- Do not use harsh chemicals or solvents when cleaning this tool.
- If you discover any damaged or broken parts, consult your local XHD distributor for replacements and advise.

Battery Disposal

- Batteries and electronics should not be disposed of in household garbage. Please return your old batteries to your local distributor for safe and environmentally friendly disposal.
- Together, we can care for the environment.

 **WARNING**

Always be sure that the tool is switched off and the battery removed before attempting to perform any inspection or maintenance.

Environment & Disposal

- Packaging materials are raw materials and can be re-used. Separate the different packaging materials and take them to the appropriate waste disposal facility. More information can be obtained from your local authorities.
- Old machines do not belong in your household garbage! Dispose of old machines appropriately, we are all responsible for the environment.



TROUBLESHOOTING

<i>FAULT</i>	<i>POSSIBLE CAUSE</i>	<i>SUGGESTED SOLUTION</i>
<i>Motor Fails to Run</i>	Battery needs charging	Recharge battery.
	Faulty wiring to motor	Remove battery, disassemble handle and check wiring for loose connection.
<i>Pressure Relief Valve Opens to Discharge Grease</i>	Blocked Line	Check lines, brazing, and grease fitting to remove or clean obstructions.
	Blocked Bearing	
	Blocked Grease fitting	
<i>Grease Gun Fails to Dispense Grease</i>	Grease tube assembly is out of grease.	Check that grease tube assembly has grease.
	Loss of prime	Repeat priming operation.
<i>Grease Gun Continues to Lose Prime</i>	Air may be trapped in several locations in container after bulk filling	Empty grease tube assembly, refill and repeat priming instructions.
	Follower may be binding in Grease tube assembly	Replace grease tube assembly.
<i>Battery Fails to Take a Charge</i>	Charger may not have power	Check that receptacle has power.
	Battery may be faulty	Replace battery.

TSC37 EXPLODED VIEW & PARTS LIST

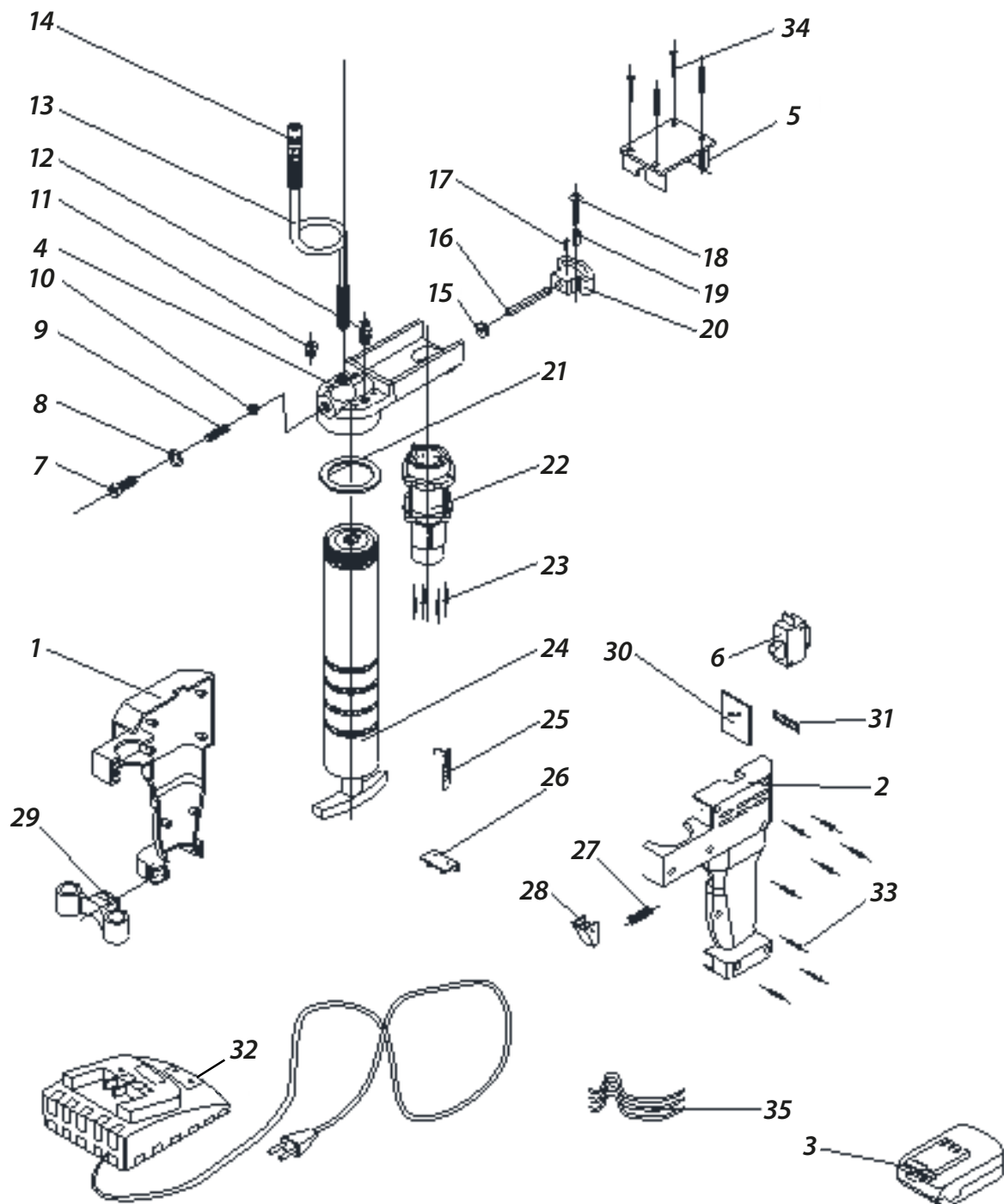

1	Left Cover	12	Vent Valve	24	Tube
2	Right Cover	13	Hose	25	Current Protection
3	Battery Pack	14	Nozzle	26	Plug
4	Pump	15	Seal Ring	27	Spring
5	Cover	16	Plunger	28	Trigger
6	Micro Switch	17	Set Screw	29	Hose Holder
7	Nut	18	Screwed Pin	30	PCB
8	Seal	19	Sleeve	31	Double Button
9	Spring	20	Ejector Pad	32	Battery Charger
10	Ball	21	Tube Seal	33	Tapping Screw
11	Filler Valve	22	Motor & Gearbox	34	Long Screw
		23	Screw	35	Wire